



TUG PLATE VIEW

INSTALLATION GUIDE



PARTS LIST

- Knob
- Swivel Mount
- Knob Screw
- Base Mount Screw
- Swivel Screw
- Base Mount

TOOL LIST

- 3mm Allen Wrench
- 5/8" Wrench

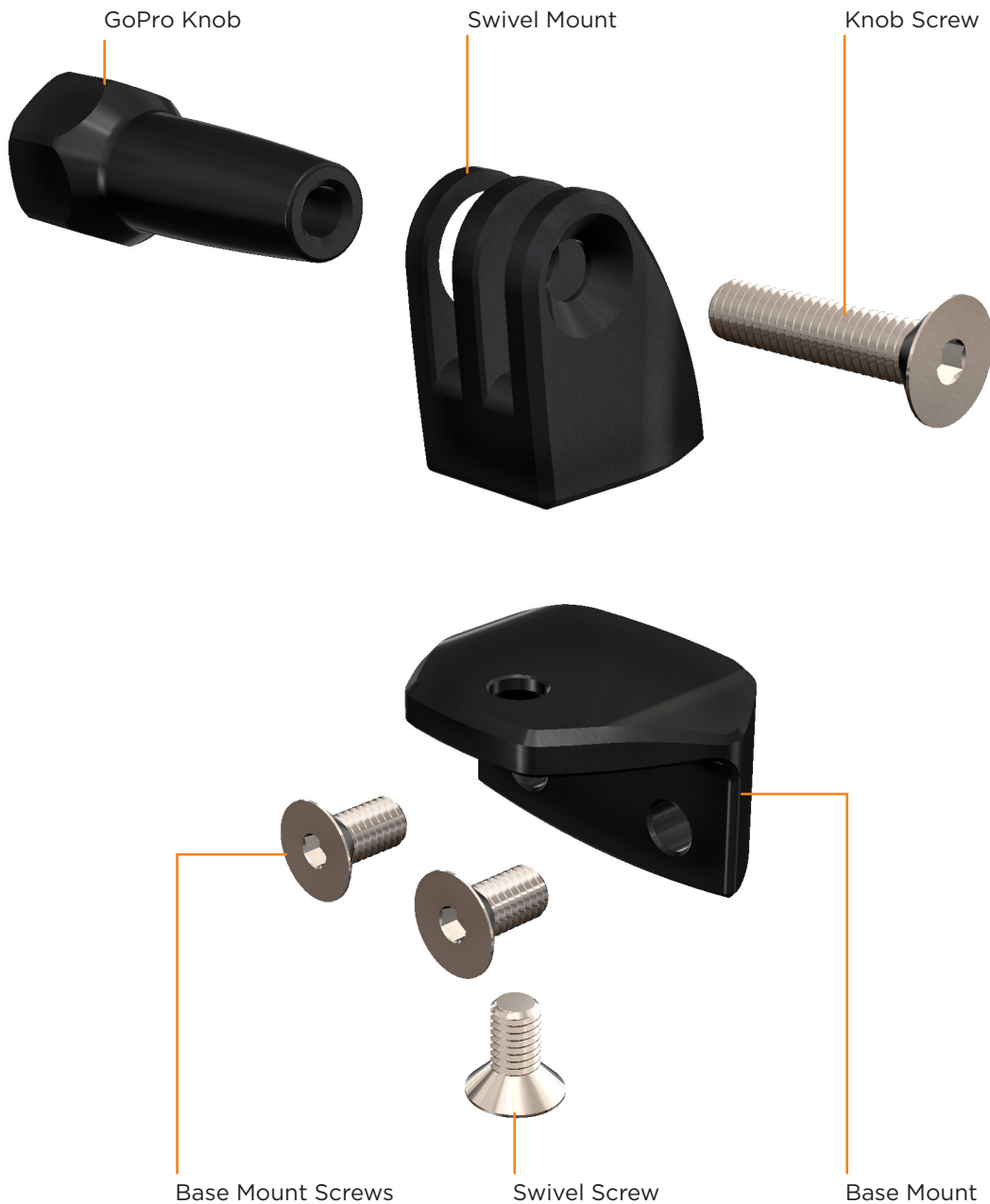

INSTALLATION GUIDE

- 1 Use a 3mm allen wrench to remove the Base Mount Screws from the Base Mount.
- 2 Align the 2 holes in the Base Mount with the holes in the top of the Tug Plate. Use the Base Mount Screws and a 3mm allen wrench to mount the Tug Plate View onto the backside of the Tug Plate
- 3 Remove the Knob and Knob Screw from the Swivel Mount.
- 4 Pass the ears of the GoPro case into the Swivel Mount. Put the Knob Screw through the holes in the Swivel Mount and thread the Knob onto the Knob Screw.
- 5 Adjust the GoPro's vertical camera angle and tighten the Knob with a 5/8" wrench.
- 6 Adjust the GoPro's horizontal camera angle by loosening the Swivel Screw with a 3mm allen wrench. Pivot the Swivel Mount and tighten the Swivel Mount Screw.
- 7 Double check all the mounting hardware to make sure it is tight.
- 8 Enjoy your new Tug Plate View footage!



NEED TECH HELP?

tech@raceseng.com